

NOTE: FINAL SIGNAGE TO BE SELECTED BY SUBARU BRAND ARCHITECT

(1) MONUMENT SIGN

OR

(1) PYLON SIGN

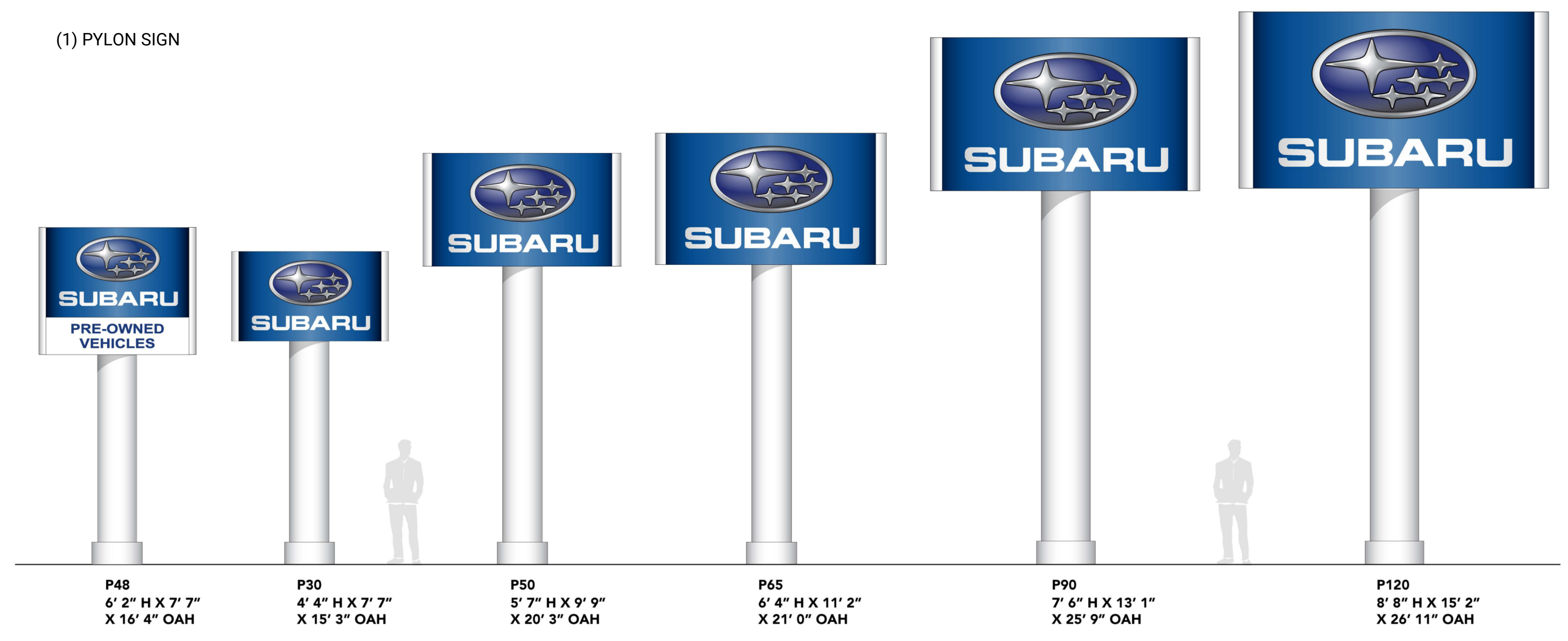
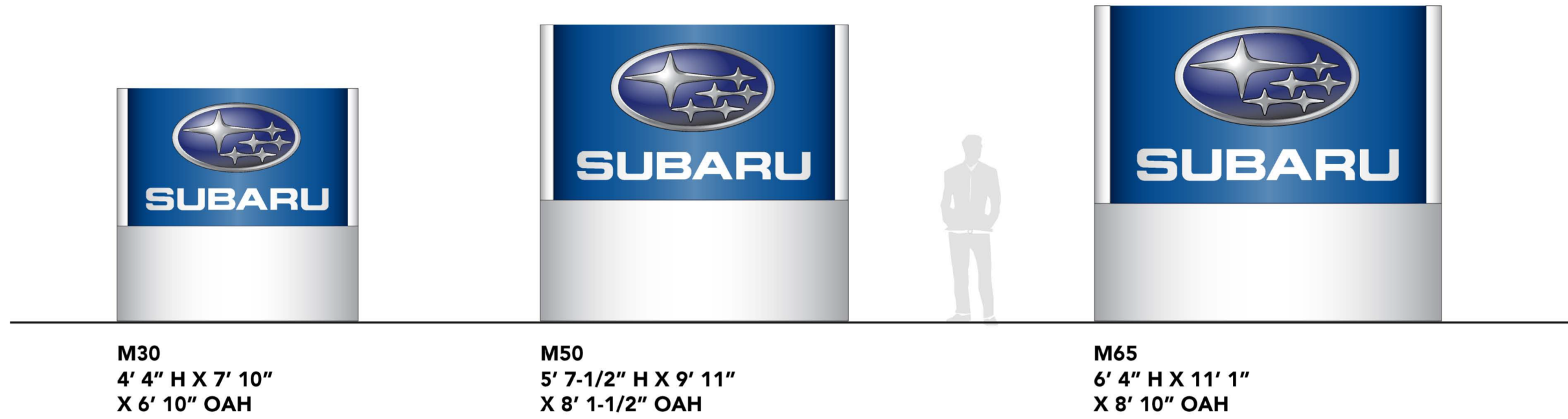

STUDIO DETROIT ARCHITECTS
 2040 PARK AVENUE, SUITE 200
 DETROIT, MICHIGAN 48226
 STUDIO-DETROIT.COM
 PROJECT MANAGER
 ADAM T. COPPERSMITH
 P. 248-240-0596
 E. ADAM@STUDIO-DETROIT.COM

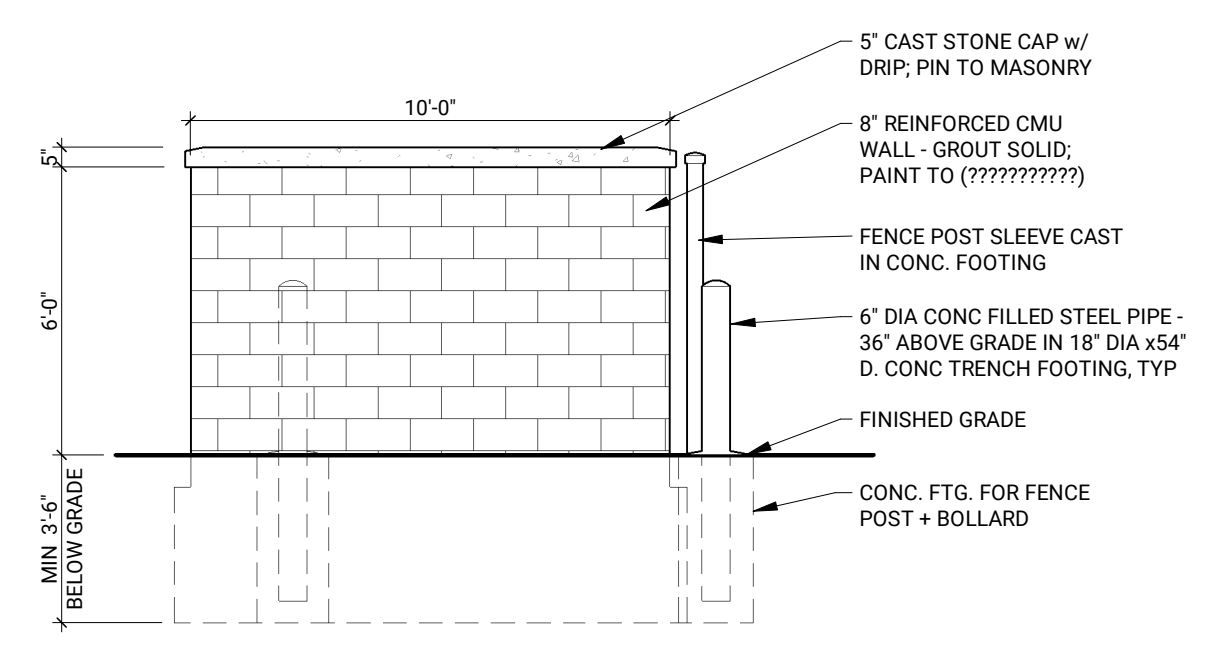

6 DUMPSTER ENCLOSURE ELEVATION @ SIDE 1/4" = 1'-0"

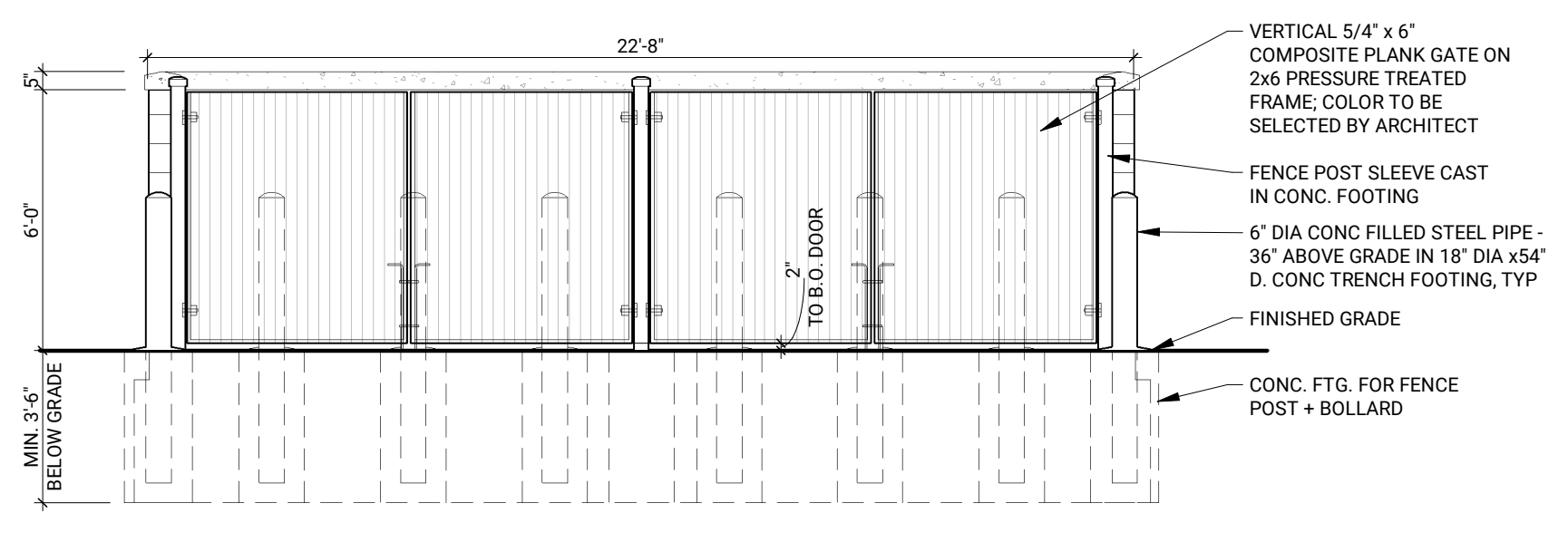

5 DUMPSTER ENCLOSURE ELEVATION @ FRONT 1/4" = 1'-0"

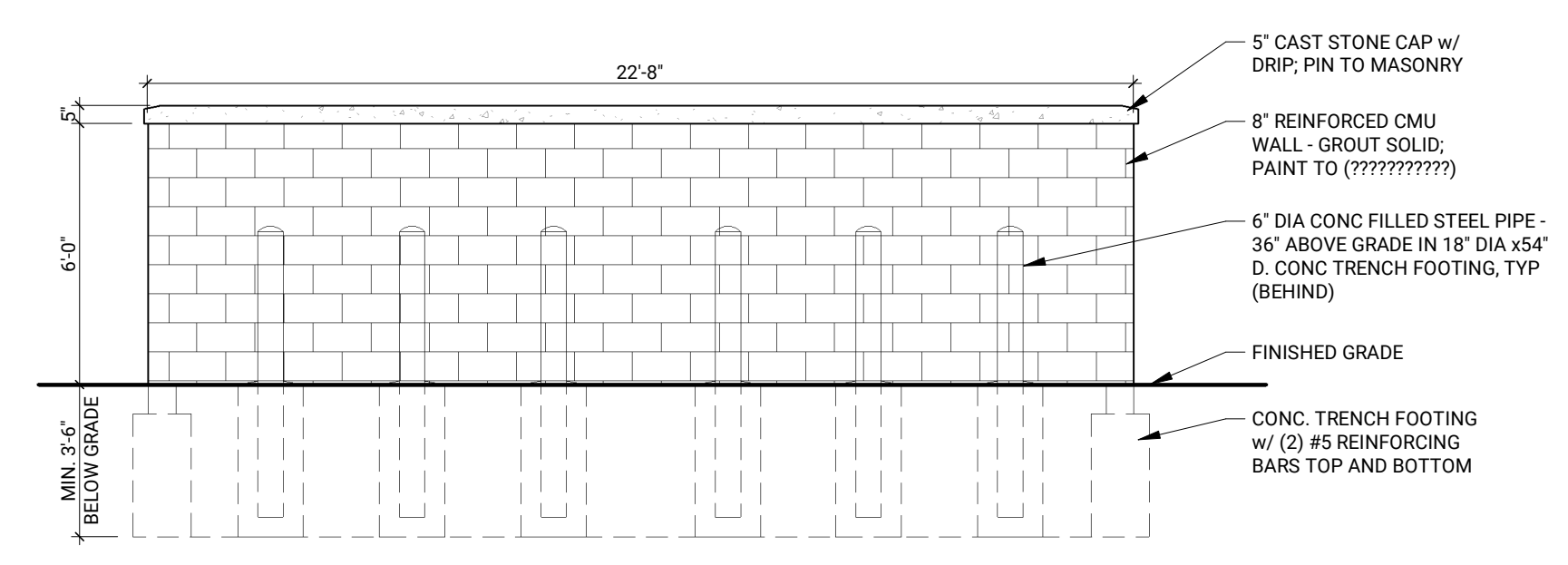

4 DUMPSTER ENCLOSURE ELEVATION @ BACK 1/4" = 1'-0"

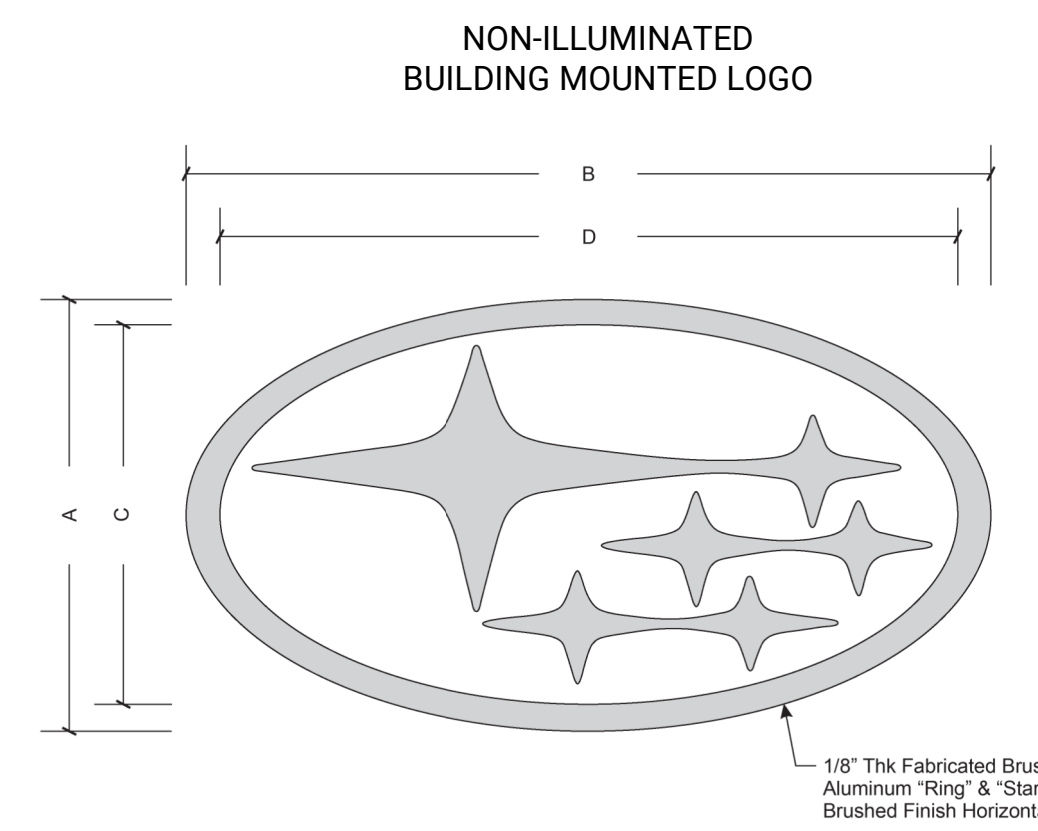

Non-Illuminated Logo	A	B	C	D
	53"	98-3/4"	46-1/2"	90-1/2"
	48"	89-7/16"	42-3/16"	82"
	36"	67"	31-5/8"	61-1/2"
	24"	44-3/4"	21"	41"

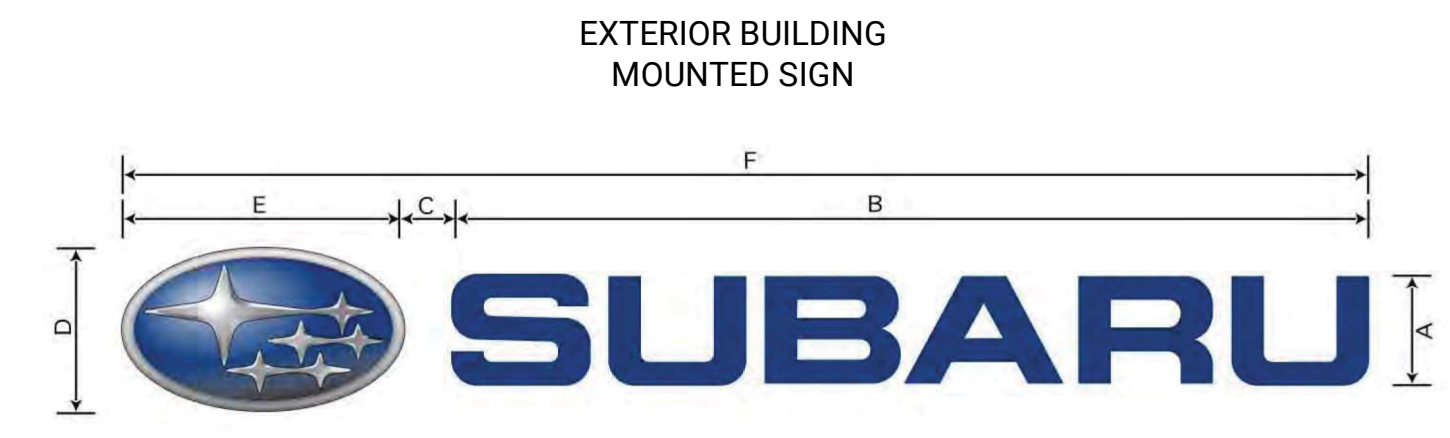

Channel Letter Schedule		ELECTRICAL LOADS	AMPS / CIRCUITS				
A	B	C	D	E	F		
36"	25 7-3/4"	14-3/8"	4 5"	8' 2"	35 0-1/8"	10.3 AMPS @ 120 VOLTS	(1) 20 AMP 120 VOLT CIR.
24"	17 1-1/4"	9-3/8"	3 0"	5' 2-1/2"	23 0-3/8"	6 AMPS @ 120 VOLTS	(1) 20 AMP 120 VOLT CIR.

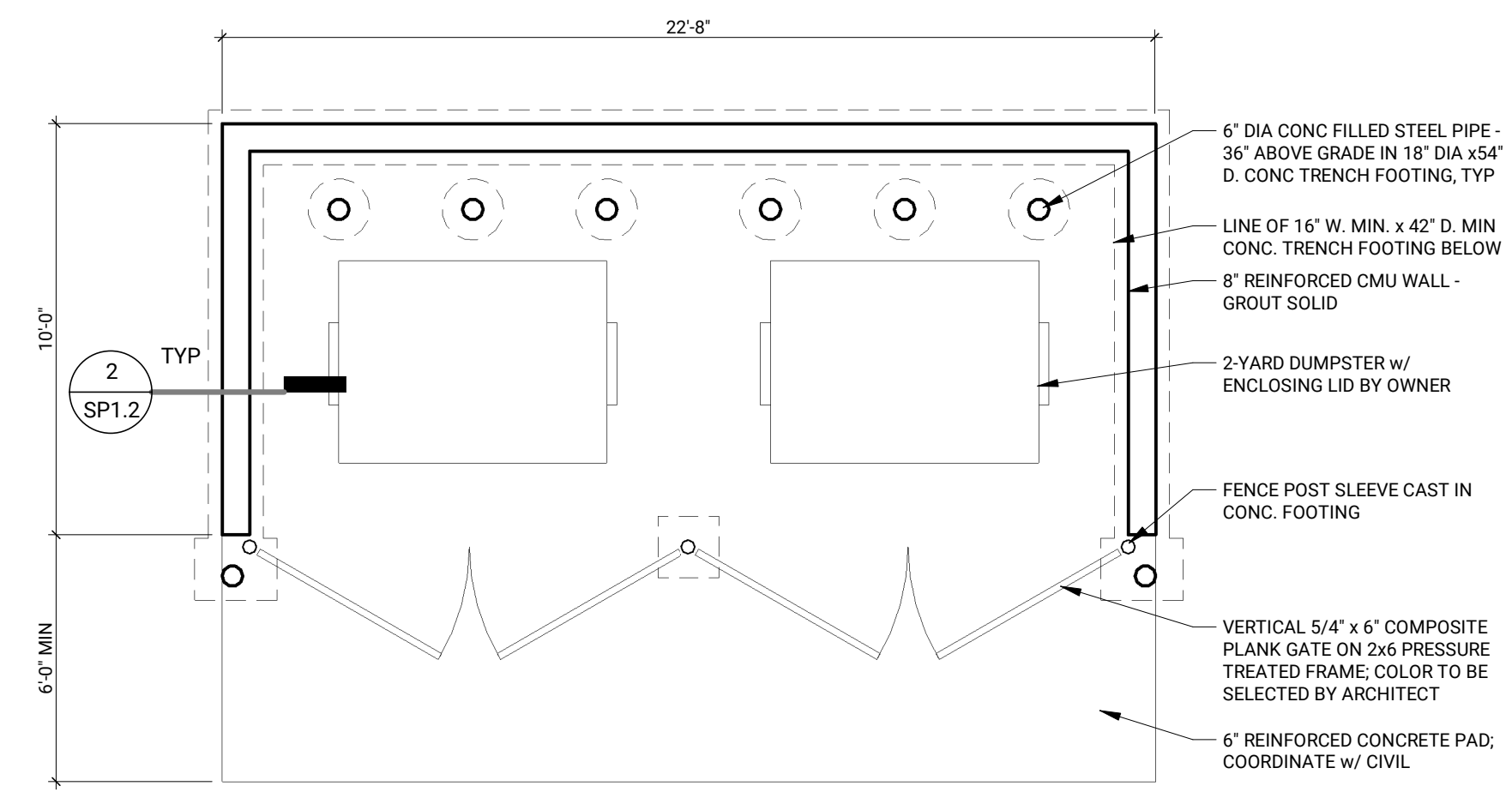

3 DUMPSTER ENCLOSURE PLAN 1/4" = 1'-0"

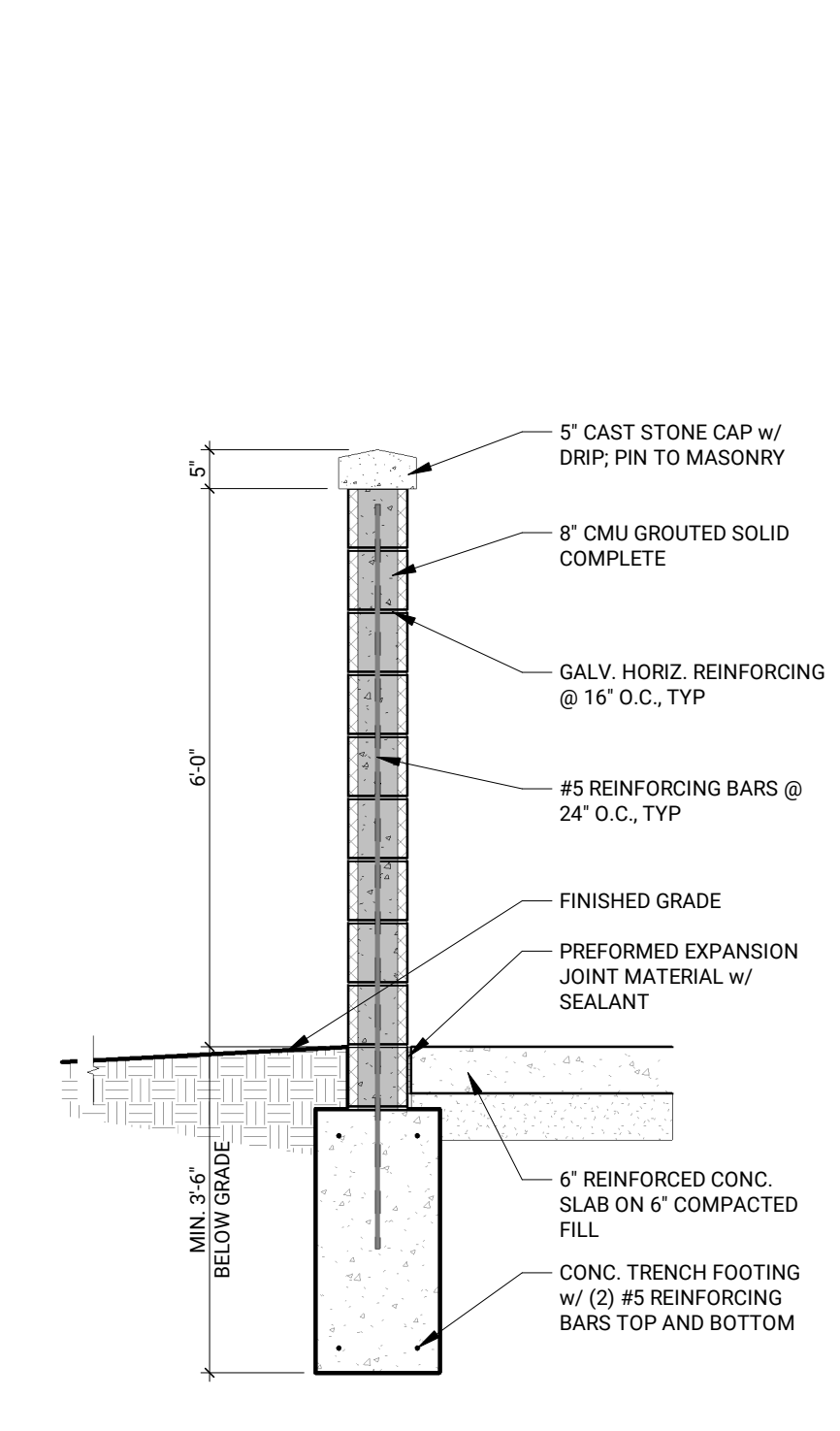

2 DUMPSTER ENCLOSURE DETAIL SP1.2 1/2" = 1'-0"

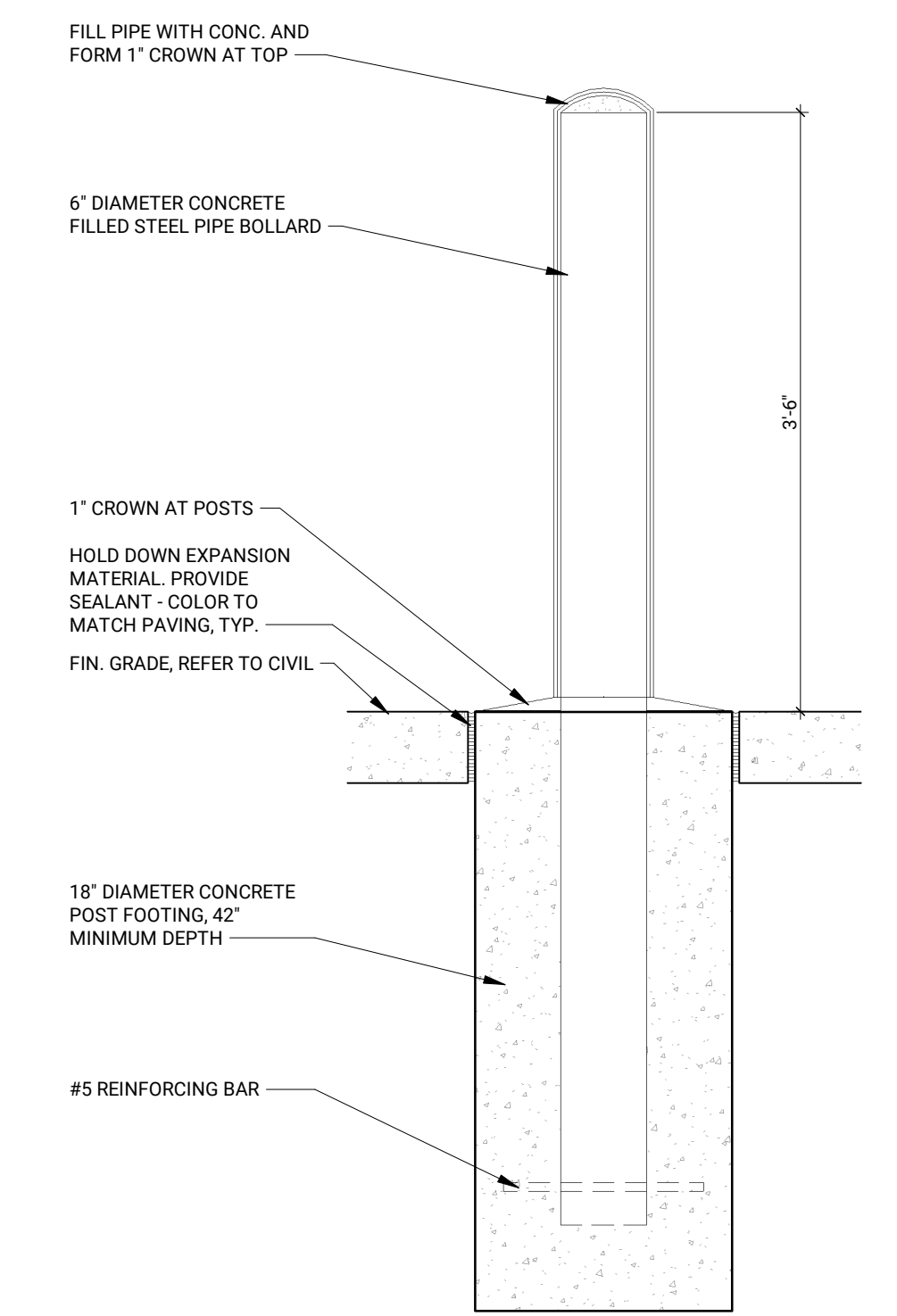

1 TYPICAL BOLLARD DETAIL 1" = 1'-0"

DO NOT SCALE DRAWINGS
 ISSUED
 10.01.24 SPA
 10.30.24 DESIGN BOARD RESPONSE
 DRAWN CLC
 CHECKED ATC
 SEAL

NOT FOR CONSTRUCTION

THIS DOCUMENT AND THE INFORMATION CONTAINED THEREIN IS THE SOLE POSSESSION OF STUDIO DETROIT AND SHALL NOT BE ALTERED OR MODIFIED WITHOUT THE EXPRESS WRITTEN PERMISSION OF STUDIO DETROIT. ANY MODIFICATION OR ALTERATION THEREOF SHALL INDEMNIFY AND HOLD HARMLESS STUDIO DETROIT OF ALL EXPENSES, CLAIMS AND/OR LIABILITY RESULTING FROM SUCH MODIFICATIONS OR ALTERATIONS.
 ©2024 STUDIO DETROIT LLC

CLIENT
SERRA AUTOMOTIVE GROUP
 PROJECT
SERRA SUBARU NEW DEALERSHIP
 1089 INTERSTATE PKWY
 AKRON, OHIO, 44312
 PROJECT NO. 24021

ARCHITECTURAL SITE DETAILS
SP1.2